

STUDIU DE OPORTUNITATE

Elaborare P.U.Z. si R.L.U. :
"Construire locuinte colective cu spatii comerciale si birouri"

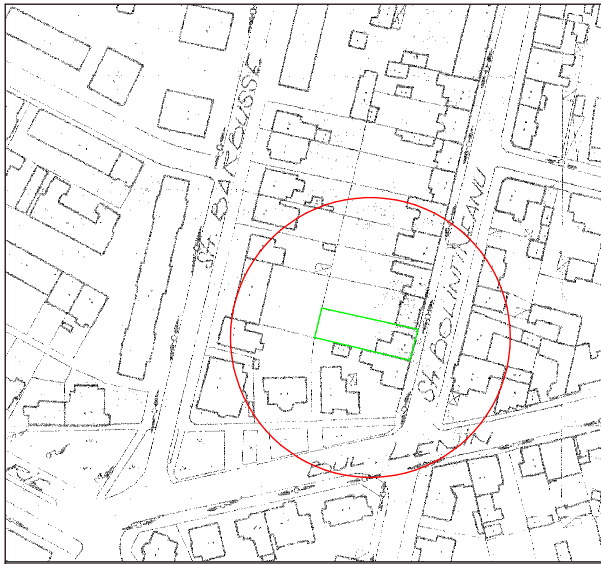
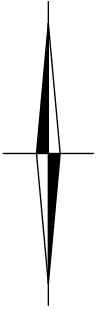

AMPLASAMENT

INCADRARE IN TERITORIU (FARA SCARA)

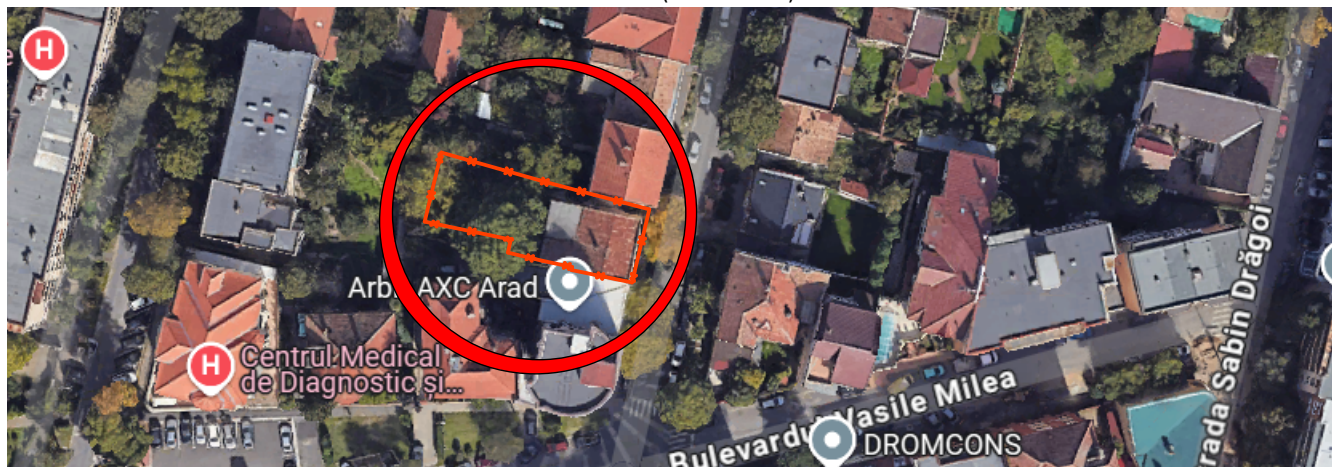

PLAN DE INCADRARE IN ZONA S.C. 1:1000

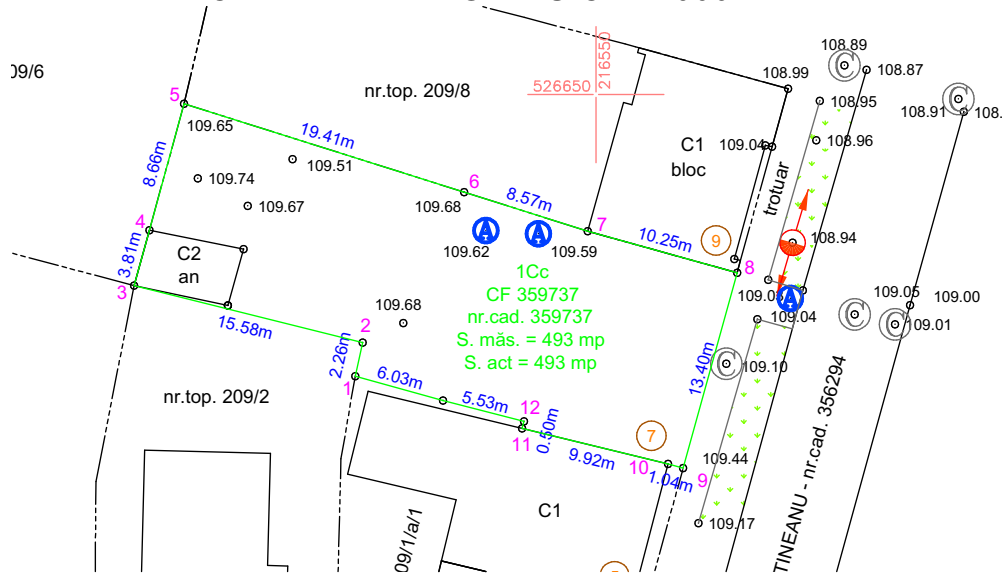

CALITATE	NUME	SEMANTURA	CERINTA	REFERAT / EXPERTIZA NR.	DATA
EXPERT					
VERIFICATOR					
ZUBCU proiectare & consultanta ULTRARCH LTD S.R.L. str. Crisan, nr. 9 Sighisoara, Jud. Mures tel: +4 0749 322 701 mihaizubcu@gmail.com www.zubcu.ro				Beneficiar: BUTACI SOFIA Jud. Arad, Mun. Arad, Cal. Aurel Vlaicu bl. Z19 sc. B ap. 7	Nr. proiect: 02/2025
				Titlu proiect: Elaborare PUZ si RLU "Construire locuinte colective cu spatii comerciale si birouri" Jud. Arad, Mun. Arad, Str. Dimitrie Bolintineanu, nr. 7, CF 359737	Faza: S.O.
SPECIFICATIE	NUME	SEMANTURA	Scara:	Titlu plansa: INCADRARE IN ZONA	Plansa nr.: 01 URB
SEF PROIECT	arh. Zubcu Mihai		Format: 1:500 A4		
PROIECTAT	arh. Zubcu Mihai		Data: februarie 2025		
DESENAT	arh. Zubcu Mihai				